

Raised Toilet Seats

Product Code: RRT103 - 150mm (6")
RRT105 - 100mm (4")
RRT107 - 150mm (2")

Available in 3 sizes, 150mm (6"), 100mm (4") or 50mm (2"), these raised toilets seats will assist patients in lowering themselves onto the toilet, and raising from it.

Made of a lightweight plastic, these seats are gently contoured and resistant to stains and odours.

They fix easily to most toilets.

12 months warranty (conditions apply)



Specifications	RRT103	RRT105	RRT107
Length	40cm	40cm	40cm
Width:	39cm	39cm	39cm
Height:	15cm	10cm	5cm
Weight Capacity:	114kg	114kg	114kg

Instructions

- Some toilets may require the existing seat and lid to be removed prior to installing the raised toilet seat.
- Thoroughly clean the area, ensuring that the toilet bowl is dry.
- Rotate the locking clamp in a counter clockwise motion to open up the clamps.
- Place the raised toilet seat on the toilet bowl with the lip facing the front.
- Apply a light amount of pressure to the front of the seat while turning the locking clamp in a clockwise motion. Turn until seat is secure.
- Adjust both clamps at the same time to ensure that the raised toilet seat remains centred.

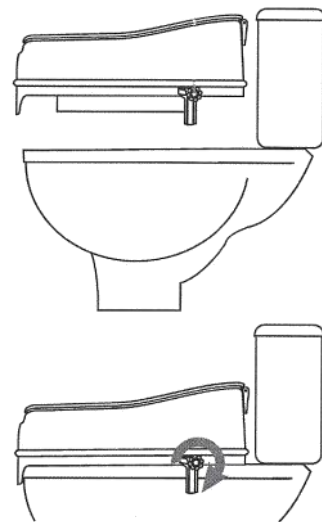

Care and Maintenance

- Ensure all locking clamps are securely tightened.
- Regularly clean with warm soapy water. For tougher stains use a light cream cleanser.

Spare Parts

- Locking Clamp: ST0336 (sold each)

Warranty

- Pharmaquip Healthcare offers a one year conditional warranty for domestic use of this product.
- If this product is used for commercial purposes (for example, hire), the warranty period is limited to 6 months.
- Pharmaquip Healthcare warrants its products to be free from defects in material and workmanship.
- Pharmaquip Healthcare will repair or replace any part, provided the product is delivered, pre-paid, to a location authorised by Pharmaquip Healthcare within the prescribed period.
- This warranty does not include parts subject to wear and tear.
- This warranty does not cover damage caused by misuse, neglect, accident or improper use.
- Warranties issued by Pharmaquip Healthcare will be limited to repair or replacement of the defective product.
- Pharmaquip Healthcare will not be liable for any consequential or incidental damages whatsoever.
- This product is intended to be used as a toilet aid. Pharmaquip Healthcare will not be liable for any other improper use.